

Soils Map

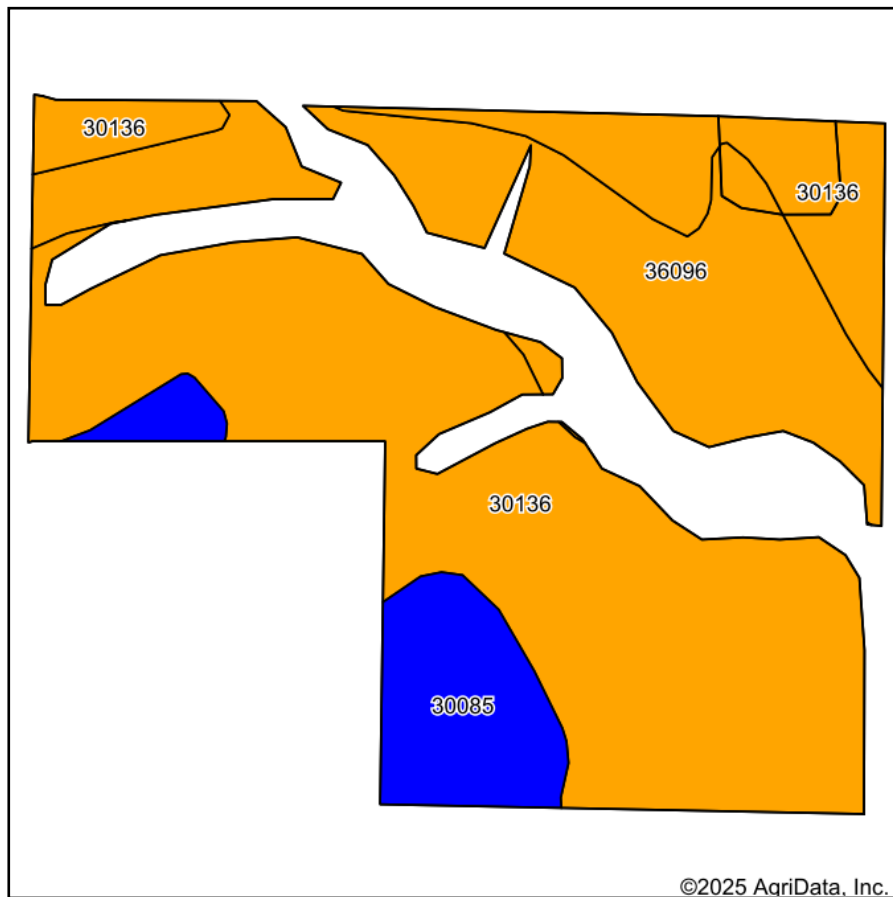

Soils data provided by USDA and NRCS.

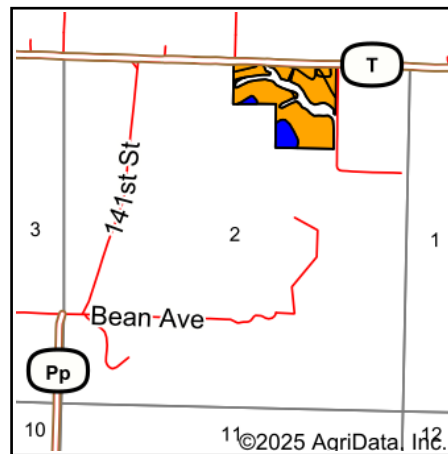

State: **Missouri**
 County: **Daviess**
 Location: **2-61N-29W**
 Township: **Benton**
 Acres: **30.61**
 Date: **3/24/2025**



Maps Provided By:



© AgriData, Inc. 2023

www.AgriDataInc.com



Area Symbol: MO061, Soil Area Version: 27

Code	Soil Description	Acres	Percent of field	Non-Irr Class Legend	Non-Irr Class *c	Alfalfa hay Tons	Caucasian bluestem Tons	Common bermudagrass Tons	Orchardgrass red clover Tons	Tall fescue Tons	Warm season grasses Tons	*n NCCPI Overall	*n NCCPI Corn	*n NCCPI Small Grains	*n NCCPI Soybeans
30136	Lamoni loam, 5 to 9 percent slopes	19.17	62.6%		Ille	5	8	7	8	7	8	62	56	61	
36096	Zook silty clay loam, 1 to 5 percent slopes, frequently flooded	8.20	26.8%		Illw			8	7	8	8	74	74	58	
30085	Grundy silt loam, 2 to 5 percent slopes	3.24	10.6%		lle							74	74	69	
Weighted Average					2.89	3.1	5	6.5	6.9	6.5	7.2	*n 66.5	*n 62.7	*n 61	*n

*n: The aggregation method is "Weighted Average using all components"

*c: Using Capabilities Class Dominant Condition Aggregation Method